

Dorsey's indicating plug gages are used for repetitive bore measurement applications where extreme accuracy is important. These high accuracy gages often take the place of air or electronic bore gages.

FEATURES:

- ✓ Self centering plug head eliminates operator influence for extremely accurate applications.
- ✓ Non tipping design offers fast, simple, and accurate results.
- ✓ Carbide contacts are housed and protected by a dedicated hardened steel sleeve which is ground approximately .001" smaller than the lower limit of the bore being inspected.
- ✓ Single dial unit housing can be used with interchangeable plug heads.
- ✓ Plug heads: choice of 3 "H" dimensions allows measurement of thru bores, blind holes, or super blind holes.

PLUG HEAD DIAMETER		THRU BORES H=.400"	BLIND BORES		SUPER BLIND BORES H=.039"
INCHES	MM	HEAD	HEAD	H DIM	HEAD PART #
.098 - .117	2.5 - 2.9	N/A	D240-035	1.5mm	N/A
.118 - .157	3.0 - 4.0	D240-400	D240-040	1.5mm	D240-500
.158 - .236	4.1 - 6.0	D240-405	D240-050	1.8mm	D240-505
.237 - .472	6.1 - 12.0	D240-410	D240-052	2.5mm	D240-510
.473 - .787	12.1 - 20.0	D240-415	D240-055	2.5mm	D240-515
.788 - 1.181	20.1 - 30.0	D240-420	D240-060	2.5mm	D240-520
1.182 - 1.574	30.1 - 40.0	D240-425	D240-065	3.5mm	D240-525
1.575 - 2.362	40.1 - 60.0	D240-430	D240-070	3.5mm	D240-530
2.363 - 3.150	60.1 - 80.0	D240-435	D240-075	4.0mm	D240-535
3.151 - 3.937	80.1 - 100.0	D240-440	D240-080	4.0mm	D240-540
3.938 - 4.331	100.1 - 110.0	D240-445	D240-085	4.0mm	D240-545
4.332 - 4.724	110.1 - 120.0	D240-450	D240-090	4.0mm	D240-550
4.725 - 5.118	120.1 - 130.0	D240-455	D240-095	4.0mm	D240-555
5.119 - 5.512	130.1 - 140.0	D240-460	D240-100	4.0mm	D240-560
5.513 - 5.906	140.1 - 150.0	D240-465	D240-105	4.0mm	D240-565
5.907 - 6.299	150.1 - 160.0	D240-470	D240-110	4.0mm	D240-570
6.300 - 6.693	160.1 - 170.0	D240-475	D240-115	4.0mm	D240-575
6.694 - 7.087	170.1 - 180.0	D240-480	D240-120	4.0mm	D240-580
7.088 - 7.480	180.1 - 190.0	D240-485	D240-125	4.0mm	D240-585
7.481 - 7.874	190.1 - 200.0	D240-490	D240-130	4.0mm	D240-590
7.875 - 9.000	200.1 - 230.0	D240-616	D240-617	4.0mm	N/A
PART# 1199	Plug head adapter, (to 5/8 dial unit housing)				
-DS	Depth stop				
D240-315	Right angle attachment w/.040" (1mm) Travel				

HOW TO ORDER:

1. Select measurement head size, specify check diameter and min/max bore sizes
2. Determine if extension is required
3. Select adapter # for dial unit housing
4. Select an indicating device (see pages 10 & 11)

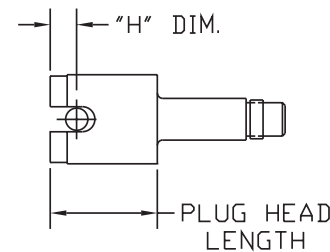
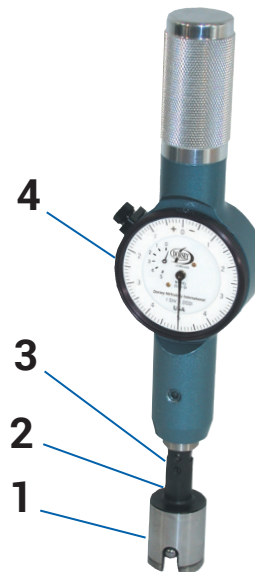

Depth stops available upon request

DEPTH EXTENSIONS FOR USE ON HEADS WITH DIAMETERS GREATER THAN .49" (12.5mm)	
PART #	DESCRIPTION
D240-309	3.9" (100mm) X .47" (12mm) DIAMETER
D240-310	9.8" (250mm) X .47" (12mm) DIAMETER
D240-311	19.7" (500mm) X .47" (12mm) DIAMETER
D240-312	29.5" (750mm) X .47" (12mm) DIAMETER
D240-313	40" (1000mm) X .47" (12mm) DIAMETER